

LUBRICATION : MARQUESA (MA12, 16, 20, 30, 20T, 30T)

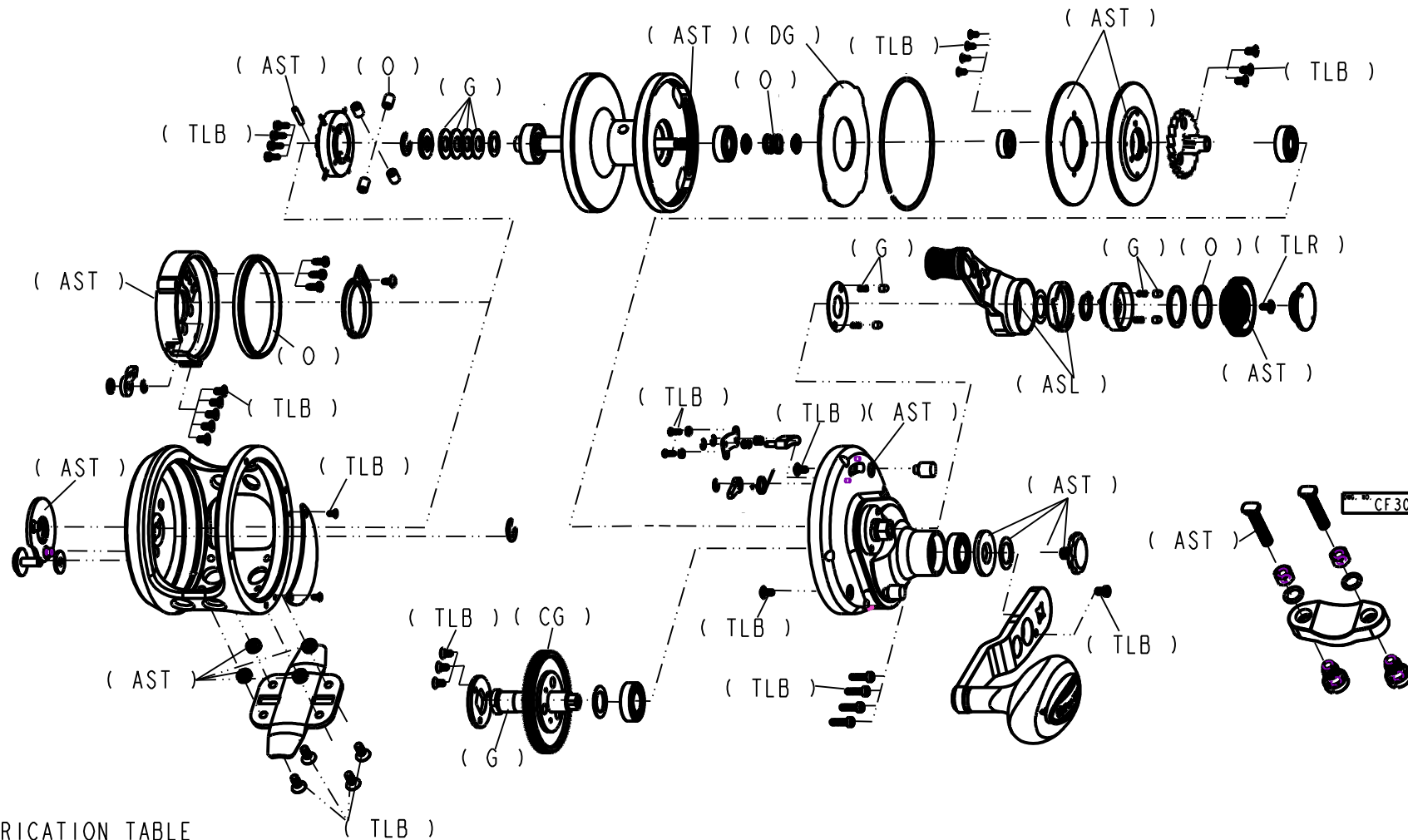

Part No. CF300LUB

LUBRICATION TABLE

- (O) - Oil , Hot Source
- (G) - Grease , Hot Sauce
- (CG) - Clutch Grease , Nye 788A
- (DG) - Drag Grease , Cal's grease
- (ASL) - Anti Seize , Loctite 51607
- (AST) - Anti Seize , Tef-Gel
- (TLB) - Thread locking , Loctite 242 Blue
- (TLR) - Thread locking , Loctite 262 Red

DIMENSIONS AND TOLERANCES PER ISO		TOLERANCES EXCEPT AS NOTED ANGLES TOLERANCE		W.C. BRADLEY / ZEBCO HOLDINGS, INC P.O. BOX 270 TULSA, OKLAHOMA	
DO NOT SCALE DRAWING		OTHERS PER PROCESS STANDARD ALL DIM. ARE IN MILLIMETERS		PART NAME LUBRICATION VIEW	
PROPRIETARY NOTICE FOR DOCUMENTS This document and the information hereon is the confidential property of ZEBCO Corporation. Reproduction or use of this document or the information hereon for any purpose without the express written consent of ZEBCO Corporation is strictly prohibited.				NOTATION SYMBOLS	
<ul style="list-style-type: none"> ⊥ Flatness ⊥ Perpendicularity ⊥ Straightness ⊥ Angularity ⊙ Circularity ⊙ Total Roundness ⊙ Cylindricity ⊙ True Position ⊙ Surface Profile ⊙ Concentricity ⊙ Low Profile ⊙ Parallelism ⊙ Diameter 		DATE: 03-09-10 SCALE: 0.167 SHEET 1 OF 1		MODEL NAME: CF300 QRM No.: CF300LUB	