

Bait Cast Lubrication Spec for service

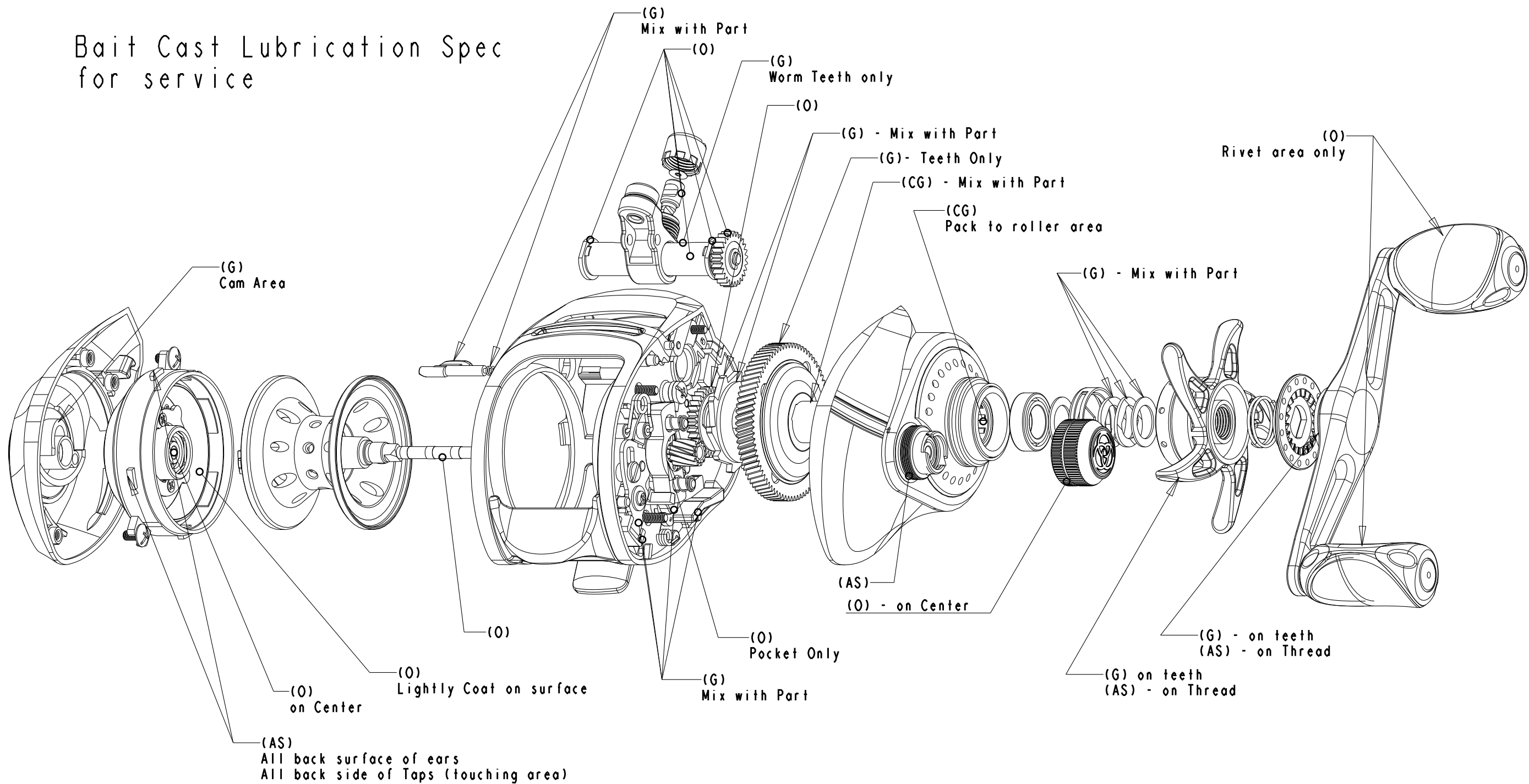

- (O): Oil - Hot Sauce
- (G): Grease - Hot Sauce
- (CG): Clutch Grease (788)
- (AS): Anti Seize (All thread on Aluminum Part)
- (TL): Thread Locking Compound

DIMENSIONS AND TOLERANCES PER ISO		TOLERANCES EXCEPT AS NOTED ANGLE: TOLERANCE: OTHERS PER PROCESS STANDARD ALL DIM. ARE IN MILLIMETERS		W.C. BRADLEY / ZEBCO HOLDINGS, INC P.O. BOX 270 TULSA, OKLAHOMA	
DO NOT SCALE DRAWING		PART NAME		DRW. BY: DATE:	
PROPRIETARY NOTICE FOR DOCUMENTS This document and the information thereon is the confidential property of ZEBCO Corporation. Reproduction or use of this document or the information hereon for any purpose without the express written consent of ZEBCO Corporation is strictly prohibited.		NOTATION SYMBOLS <ul style="list-style-type: none"> <li>▭ Flatness</li> <li>— Straightness</li> <li>○ Circularity</li> <li>⊘ Cylindricity</li> <li>⌒ Surface Profile</li> <li>— Line Profile</li> <li>∥ Parallelism</li> <li>⊥ Perpendicularity</li> <li>∠ Angularity</li> <li>⊖ Total Runout</li> <li>⊕ True Position</li> <li>⊙ Concentricity</li> <li>∅ Diameter</li> </ul>		CDR. BY: MODEL NAME: PW300-04	
		SCALE: 1.000		SHEET 1 OF 1	
		DRW. No. : PW300LUB			