

# QUANTUM

## PR600CXS

### SPECIFICATIONS:

Medium Freshwater  
 Line Capacity: 165 yds. / 12 lb.  
 Gear Ratio: 6.3:1  
 Retrieve Rate (IPT): 25.4"  
 Weight: 10.5 oz.  
 Bearings: 5 BB, 1 RB

### FEATURES:

Thumb Bar Spool Release  
 Die Cast Aluminum Frame  
 Continuous Anti-Reverse  
 Bayonet Side Cover Release  
 External Adjustable Centrifugal  
 Cast Control  
 Max-Cast Spool  
 Color: Silver / Gold

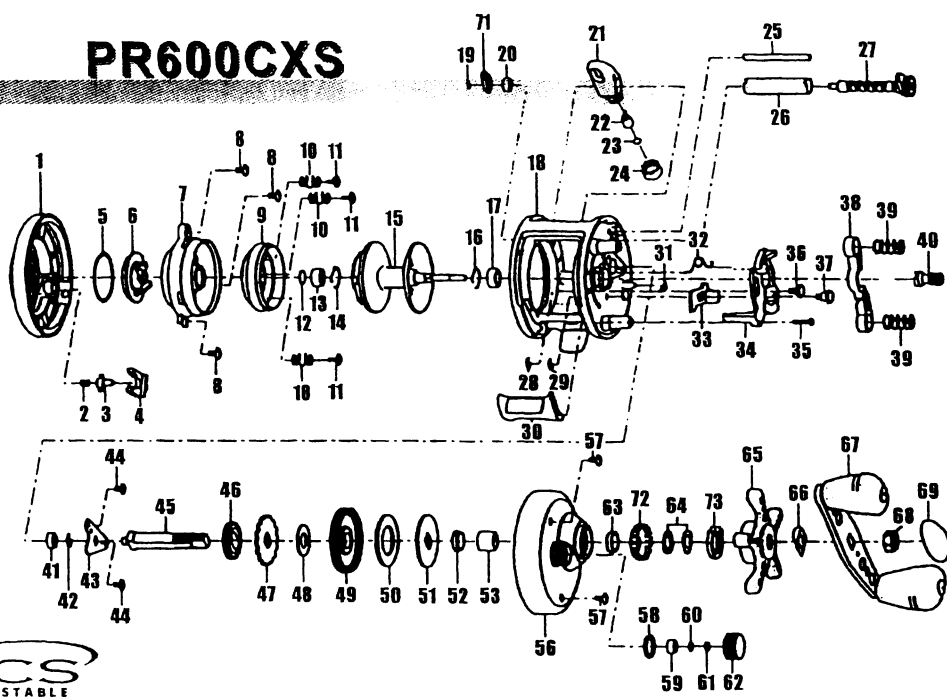

ACS  
 ADJUSTABLE  
 CENTRIFUGAL SYSTEM

Key No.	Part No.	Description	Key No.	Part No.	Description
1	RV323-01	Palm Side Cover Assembly	37	QV068-01	Kick Lever Guide Pin
2	QV096-01	Palm Side Cover Locking Spring	38	QV025-01	Pinion Yoke
3	QV095-01	Palm Side Cover Locking Pin	39	JX040-01	Pinion Yoke Spring
4	QV119-01	Palm Side Cover Release Button	40	XX011-01	Pinion Gear
5	QV111-01	Centrifugal Dial Washer	41	XX017-01	Crank Shaft Bearing
6	QV026-01	Centrifugal Dial	42	QW120-01	E-Clip
7	QV051-01	Spool Cover	43	QV002-01	Crank Shaft Retainer
8	QV125-01	Spool Cover Screw	44	JX107-01	Crank Shaft Retainer Screw
9	QV342-01	Brake Ring Assembly	45	QV008-01	Crank Shaft
10	QV070-01	Brake Ring Spring	46	<del>XX012-01</del>	O/S Drive Gear
11	QV076-01	Brake Ring Retainer Screw	47	JX083-01	Trip Ratchet
12	XX038-02	Spool Shaft Washer	48	QW111-01	Ratchet Washer
13	QV017-01	Spool Shaft Bearing (L)	49	XX012-01	Drive Gear
14	JX080-01	Clip Ring	50	JX059-01	Drag Disc
15	QV321-01	Spool Assembly	51	QV045-01	Drag "D" Washer
16	JX080-01	Clip Ring	52	QV088-01	Drag Collar
17	JX106-01	Spool Shaft Bearing (R)	53	ZW052-01	One Way Bearing Sleeve
18	RV301-01	Frame Assembly	56	RV324-03	Gear Side Cover Assembly
19	NX090-01	E-Clip	57	QW123-01	Gear Side Cover Screw
20	XX117-01	Worm Shaft Bearing	58	QW101-01	Tension Knob O-Ring
21	QV347-02	Line Guide Carrier Assembly	59	XX117-01	Tension Knob Bearing
22	JX006-03	Line Guide Pawl	60	QW032-02	Spool Tension Washer
23	JX035-01	Line Guide Pawl Washer	61	JX082-01	Spool Cushion Washer
24	JX007-02	Line Guide Carrier Screw	62	QV033-03	Spool Tension Knob
25	JX061-01	Line Guide Carrier Guide	63	RV088-01	Drag Click Ratchet Holder
26	JX016-01	Worm Shaft Guide	64	JX046-01	Spring "D" Washer
27	RV372-01	Worm Shaft Assembly	65	RV055-01	Star Drag
28	NX092-01	E-Clip	66	NX054-01	Handle Washer
29	NX092-01	E-Clip	67	QV318-02	Handle Assembly
30	QV009-01	Thumb Bar	68	RV003-01	Handle Nut
31	QV097-01	Kick Lever Spring	69	RV034-01	Handle Nut Cap
32	QV104-01	Release Slider Spring	71	RV067-01	Worm Shaft Bearing Retainer
33	QV077-01	Kick Lever	72	RV113-01	Drag Click Ratchet
34	QV039-01	Release Slider	73	RV114-01	Drag Click Pawl
35	ZW053-01	Thumb Bar Screw	74	RV080-01	Drag Click Pawl Retainer
36	QV102-01	Release Slider Guide Pin			

NOTE - Roller Bearing is included in part number 56.