

SPECIFICATIONS :

Application:

HTX2F - Lt. FW
 HTX3F - Med. FW
 HTX4F - Hvy FW

5.2:1 Gear Ratio

Line Capacity:

HTX2F - 140 yds / 6 lb
 HTX3F - 160 yds / 8 lb
 HTX4F - 180 yds / 10 lb

Retrieve Rate (Inches Per Turn):

HTX2F - 24.5"
 HTX3F - 30.2"
 HTX4F - 34.1"

Weight:

HTX2F - 9.9 oz.
 HTX3F - 12.4 oz.
 HTX4F - 13.8 oz.

5 Ball Bearings

FEATURES :

Front Drag
 Tru-Balanced Rotor
 Balanced Handle
 Oversized Twist Reducer B.B. Line Roller
 Selective On/Off (60 Stop) Anti-Reverse
 Aluminum Spool (w/ Holes in Skirt)
 Spare Graphite Spool
 Geared (S-Curve) O/S System
 Color:

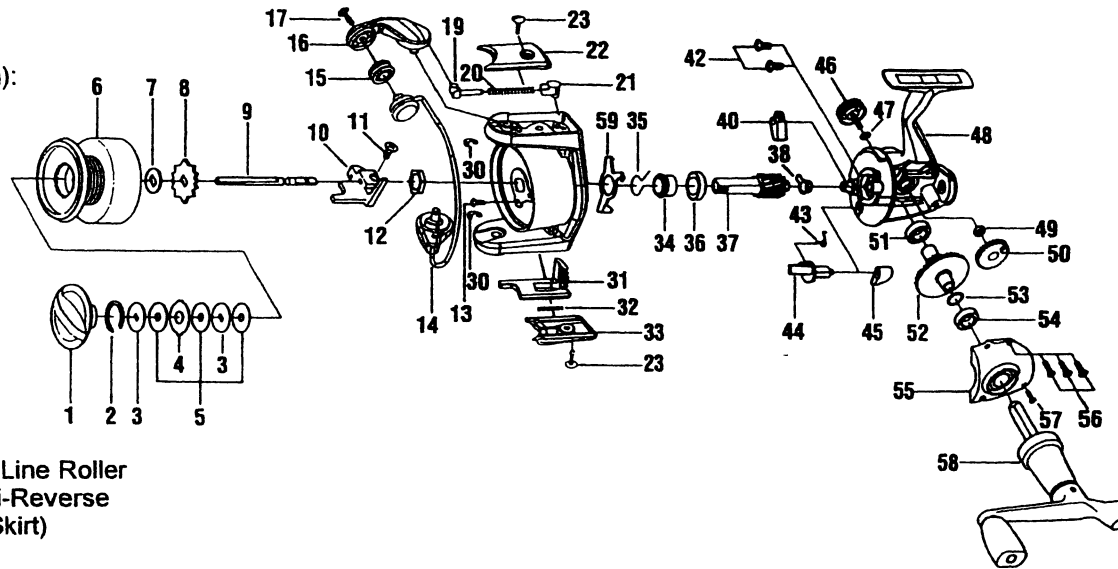

Key No.	HTX2F	Part No. HTX3F	HTX4F	Description	Price	Key No.	HTX2F	Part No. HTX3F	HTX4F	Description	Price	
1	XH332-02	←	←	Drag Knob Assy.		33	SH024-04	TH024-05	←	Kick Lever Cover		
2	RH038-01	XH038-01	←	Spool Retainer		34	WH060-01	XH060-01	←	Ratchet		
3	RH080-01	XH080-01	←	Drag Washer "D"		35	WH119-01	XH119-01	←	Slider Spring "A"		
4	RH081-01	XH081-01	←	Drag Washer "A"		36	RH028-01	AQ028-03	←	Pinion Ball Bearing		
5	RH033-01	XH033-01	←	Drag Washer "B"	12.97	37	SH011-01	TH011-01	←	Pinion Gear		
6	WH321-02	XH321-02	YH321-02	Spool Assy.		38	WH141-01	TH141-01	←	Pinion Bushing		
7	XH030-01	←	←	Spool Adj. Washer		40	WH063-01	XH063-01	←	Stopper		
8	XH037-01	←	←	Click Gear		42	TH041-01	←	←	Bearing Screw		
9	WH015-01	XH015-01	YH015-01	Main Shaft		43	TH089-01	←	←	Stopper Cam Spring		
10	WH025-01	XH025-01	←	Oscillator Slider		44	TH090-01	←	←	Stopper Cam		
11	XH100-01	←	←	Main Shaft Screw		45	TH059-01	←	←	Stopper Lever		
12	GU006-01	RU006-01	←	Rotor Nut		46	TH073-01	←	←	Handle Cap Screw		
13	GU077-08	←	←	Rotor Nut Lck. Scrw.		47	TH105-01	←	←	Handle Cap Washer		
14	WH347-03	XH347-03	YH347-03	Bail Assy.		48	WH301-02	XH301-02	XH301-04	Body Assy.		
15	BH004-14	←	←	Line Roller B.B.		49	TH158-01	←	←	O/S Gear B.B.		
16	XH007-01	←	←	Arm Lever		50	SH053-01	TH053-01	←	←	Oscillator Gear	
17	AQ108-01	←	←	Bail Screw		51	BH027-01	AQ028-03	←	←	Body Ball Bearing	
19	KQ031-01	←	←	Bail Spring Shaft		52	SH012-01	TH012-01	←	←	Drive Gear	
20	KQ049-05	←	←	Bail Spring		53	GU105-08	GU105-13	←	←	Drive Gear Adj. Wshr.	
21	QL020-01	←	←	Bail Spring Holder		54	BH027-01	AQ028-03	←	←	Body Cvr. B.B.	
22	WH087-01	XH087-01	←	Bail Spring Cover		55	SH023-07	TH023-08	TH023-15	Body Cover		
23	GU077-03	←	←	Cover Screw		56	JU057-03	←	←	←	Body Cover Screw	
29	WH009-03	XH009-03	YH009-03	Rotor		57	GU057-02	←	←	←	Body Cover Screw	
30	GH034-01	←	←	E-Clip		58	RH318-04	TH318-04	←	←	Handle Assy.	
31	SH019-01	TH019-01	UH019-01	Kick Lever		59	WH086-01	XH086-01	←	←	Slider Spring "B"	
32	TH049-01	←	←	Kick Lever Spring								

MODEL	EFFECTIVE DATE OF	
INTRODUCED : 1998	PARTS LIST/DIAGRAM: Sept. '98	DISCONTINUED : N/A