

SPECIFICATIONS :

- Ultra Lt. FW
- 125 yds / 4 lb Line Capacity
- 5.3:1 Gear Ratio
- 22.9" Retrieve Rate (inches per turn)
- 8.1 oz.
- 1 Ball Bearing

FEATURES :

- Front Drag
- Tru-Balanced Rotor
- Balanced Handle
- Oversized Twist Reducer Line Roller
- Selective On/Off (50 Stop) Anti-Reverse
- Geared (S-Curve) O/S System
- Aluminum Spool w/ holes in skirt
- Spare Graphite Spool (HTX1F only)
- Color:

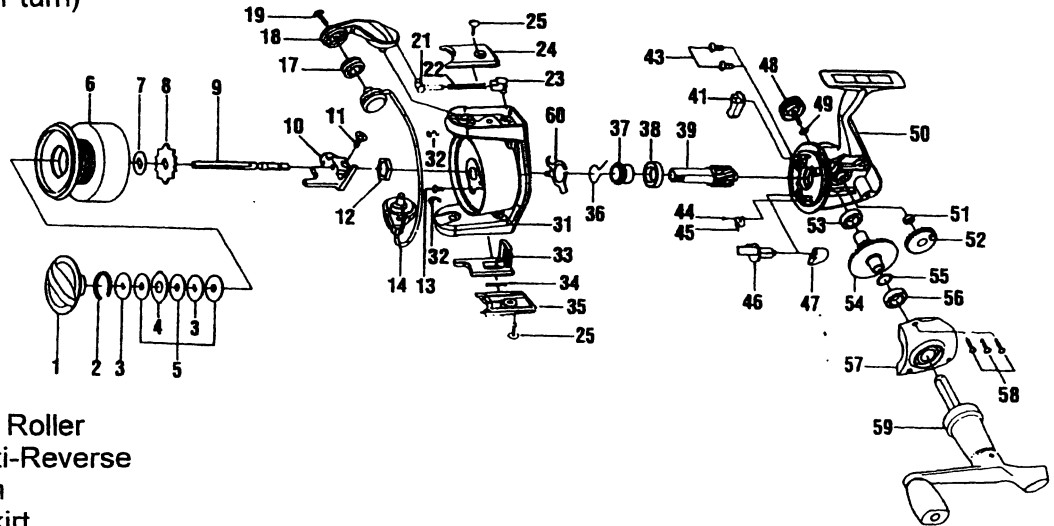

Key No.	Part No. HTX1F	Description	Price	Key No.	Part No. HTX1F	Description	Price
1	RH332-05	Drag Knob Assy.		34	KQ049-01	Kick Lever Spring	
2	RH038-01	Spool Retainer		35	RH024-05	Kick Lever Cover	
3	RH080-01	Drag Washer "D"		36	VH119-01	Slider Spring "A"	
4	RH081-01	Drag Washer "A"		37	VH060-01	Ratchet	
5	RH033-01	Drag Washer "B"		38	RH028-01	Pinion Ball Bearing	
6	RH321-05	Spool Assy.		39	RH011-01	Pinion Gear	
7	XH030-01	Spool Adj. Washer		41	VH063-01	Stopper	
8	RH037-01	Click Gear		43	RH041-01	Bearing Screw	
9	RH015-01	Main Shaft		44	TH146-01	Stopper Cam Screw	
10	RH025-01	Oscillator Slider		45	RH089-01	Stopper Cam Spring	
11	XH100-01	Main Shaft Screw		46	RH090-01	Stopper Cam	
12	GU006-01	Rotor Nut		47	TH059-01	Stopper Lever	
13	GU077-08	Rotor Nut Lck. Scrw.		48	TH073-01	Handle Cap Screw	
14	VH347-01	Bail Assy.		49	TH105-01	Handle Cap Washer	
17	BH004-02	Line Roller B.B.		50	VH301-02	Body Assy.	
18	VH007-01	Arm Lever		51	TH158-01	O/S Gear B.B.	
19	AQ108-01	Bail Screw		52	RH053-01	Oscillator Gear	
21	KQ031-01	Bail Spring Shaft		53	BH027-01	Body Ball Bearing	
22	KQ049-05	Bail Spring		54	RH012-01	Drive Gear	
23	QL020-01	Bail Spring Holder		55	GU105-08	Drive Gear Adj. Wshr.	
24	VH087-01	Bail Spring Cover		56	BH027-01	Body Cvr. B.B.	
25	GU077-03	Cover Screw		57	RH023-05	Body Cover	
31	VH009-01	Rotor		58	GU057-02	Body Cover Screw	
32	GH034-01	E-Clip		59	RH318-04	Handle Assy.	
33	KQ049-01	Kick Lever		60	VH086-01	Slider Spring "B"	

MODEL	EFFECTIVE DATE OF	
INTRODUCED : 1998	PARTS LIST/DIAGRAM: Sept. '98	DISCONTINUED : N/A