

## SPECIFICATIONS :

Hvy FW / Med. Lt. SW  
225 yds / 12 lb Line Capacity

### Ball Bearings:

BR150 - 1 B.B.  
BR350 / BR350A - 3 B.B.

4.8:1 Gear Ratio  
13.8 oz.

## FEATURES :

Front Drag  
Balanced Rotor  
Oversized Twist Reducer Line Roller  
POSI-Loc Selective Anti-Reverse (15 stop)  
Aluminum Long Stroke Max-Cast Spool  
Color: BR150 / 350 - Light Tan  
BR350A - Dark Grey

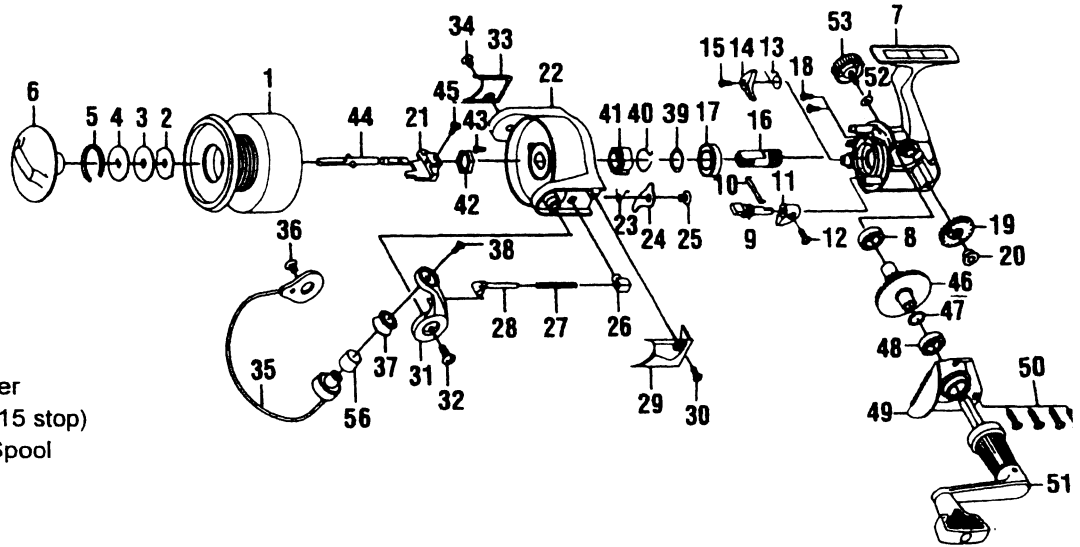

Key No.	Part No.	DESCRIPTION	Price	Key No.	Part No.	DESCRIPTION	Price	
1	BH321-31	Spool Assembly	8.22	29	N / A	Arm Lever Cover (BR350A)	2.2	
1	N / A	Spool Assembly (BR350A)	8.22	30	BH085-11	Cover Screw	0.4	
2	BH081-21	Spool Washer "A"	0.59	30	N / A	BH085-13 Cover Screw (BR350A)	0.4	
3	BH033-21	Spool Washer "B"	0.64	31	BH007-12	Arm Lever	3.1	
4	BH080-31	Spool Washer "D"	0.96	31	N / A	BH007-13 Arm Lever (BR350A)	3.1	
5	BH038-21	Drag Retainer	1.01	32	BH044-11	Arm Lever Screw	0.6	
6	BH332-31	Drag Knob Assembly	3.29	32	N / A	BH044-13 Arm Lever Screw (BR350A)	0.6	
6	N / A	Drag Knob Assembly (BR350A)	3.29	33	BH024-31	Bail Holder Cover	1.6	
7	BH001-31	Body (before A8 date code)	5.57	33	N / A	BH024-33 Bail Holder Cover (BR350A)	1.6	
7	BH001-38	Body (after A8 date code)	5.57	34	BH085-11	Cover Screw	0.6	
7	N / A	Body (BR350A)	5.57	34	N / A	BH085-13 Cover Screw (BR350A)	0.6	
8	BH027-11	N / A	0.77	35	BH347-32	Bail Assembly	5.7	
8	N / A	BH027-12	6.58	35	N / A	BH347-37 Bail Assembly (BR350A)	5.7	
9	BH090-11	Stopper Cam	1.60	36	BH044-11	Bail Holder Screw	0.6	
10	BH089-11	Stopper Cam Spring	0.96	36	N / A	BH044-13 Bail Holder Screw (BR350A)	0.6	
11	BH059-11	Stopper Lever	1.08	37	BH004-12	Line Roller	3.1	
11	N / A	BH059-14	1.08	38	BH108-11	Bail Screw	0.6	
12	BH135-11	Stopper Lever Screw	0.64	38	N / A	BH108-13 Bail Screw (BR350A)	0.6	
12	N / A	BH135-12	0.64	39	BH110-31	Bearing Washer	0.5	
13	BH061-11	Stopper Spring	0.46	40	BH086-31	Silent Spring	1.6	
14	BH063-32	Stopper	1.49	41	BH060-32	Ratchet Gear	1.7	
15	BH077-11	Stopper Screw	0.64	42	BH006-31	Rotor Nut	1.1	
16	BH011-31	Pinion Gear (before A8 date code)	2.76	43	BH094-11	Rotor Nut Lock Screw	0.9	
16	BH011-32	Pinion Gear (after A8 & BR350A)	2.76	44	BH315-31	Main Shaft Assembly	6.21	
17	BH028-31	Ball Bearing (before A8 date code)	8.70	45	BH100-11	Main Shaft Screw	0.64	
17	BH028-32	Ball Bearing (after A8 & BR350A)	8.70	46	BH012-31	Driver Gear	2.4	
18	BH041-11	Bearing Screw	0.64	47	BH026-11	Adjust Washer	0.65	
19	BH053-31	O/S Gear	1.53	48	BH027-11	N / A	Bushing	0.77
20	BH158-11	O/S Gear Bushing	0.98	48	N / A	BH027-12	Ball Bearing	6.58
21	BH025-11	O/S Slider	2.66	49	BH023-31	Body Cover	3.45	
22	BH009-31	Rotor	5.84	49	N / A	BH023-37	Body Cover (BR350A)	3.45
22	N / A	BH009-37	5.84	50	BH057-11	Body Cover Screw	0.64	
23	BH049-31	Kick Lever Spring	0.96	50	N / A	BH057-13	Body Cover Screw (BR350A)	0.64
24	BH019-31	Kick Lever	1.91	51	BH318-31	Handle Assembly	6.37	
25	BH136-11	Kick Lever Screw	0.64	51	N / A	BH318-37	Handle Assembly (BR350A)	6.37
26	BH020-11	Spring Holder	0.96	52	BH105-11	Handle Cap Washer	0.47	
27	BH022-31	Arm Lever Spring	0.64	53	BH073-31	Handle Screw Cap	2.34	
28	BH031-31	Spring Shaft	0.96	53	N / A	BH073-33	Handle Screw Cap (BR350A)	2.34
29	BH046-31	Arm Lever Cover	2.22	56	BH016-11	Line Roller Bushing	1.06	

☐ = These parts are not interchangeable with parts from different date code (ie., use Pinion Gear before A8 along with Ball Bearing and Body before A8)